

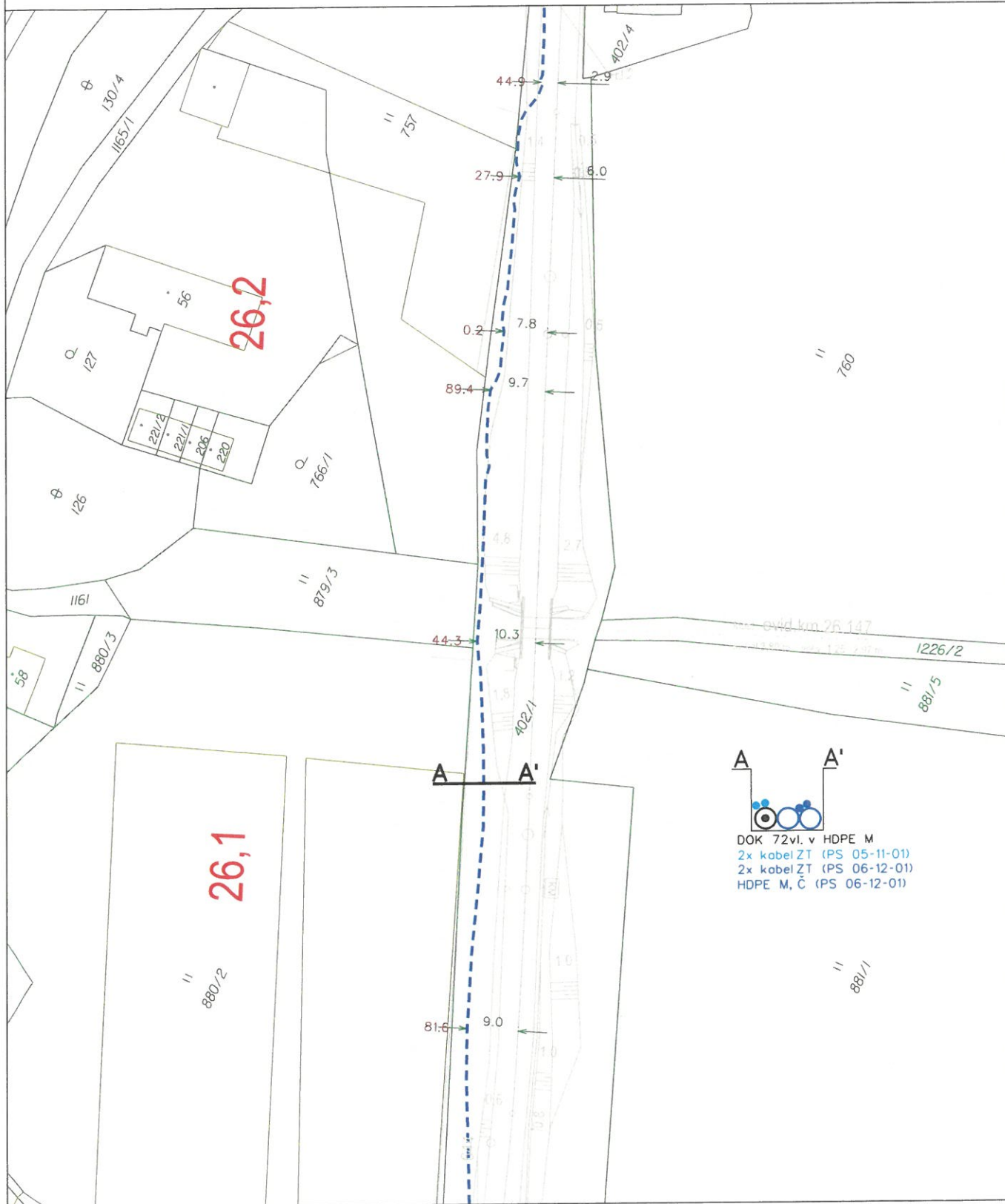

List č. 115



List č. 113



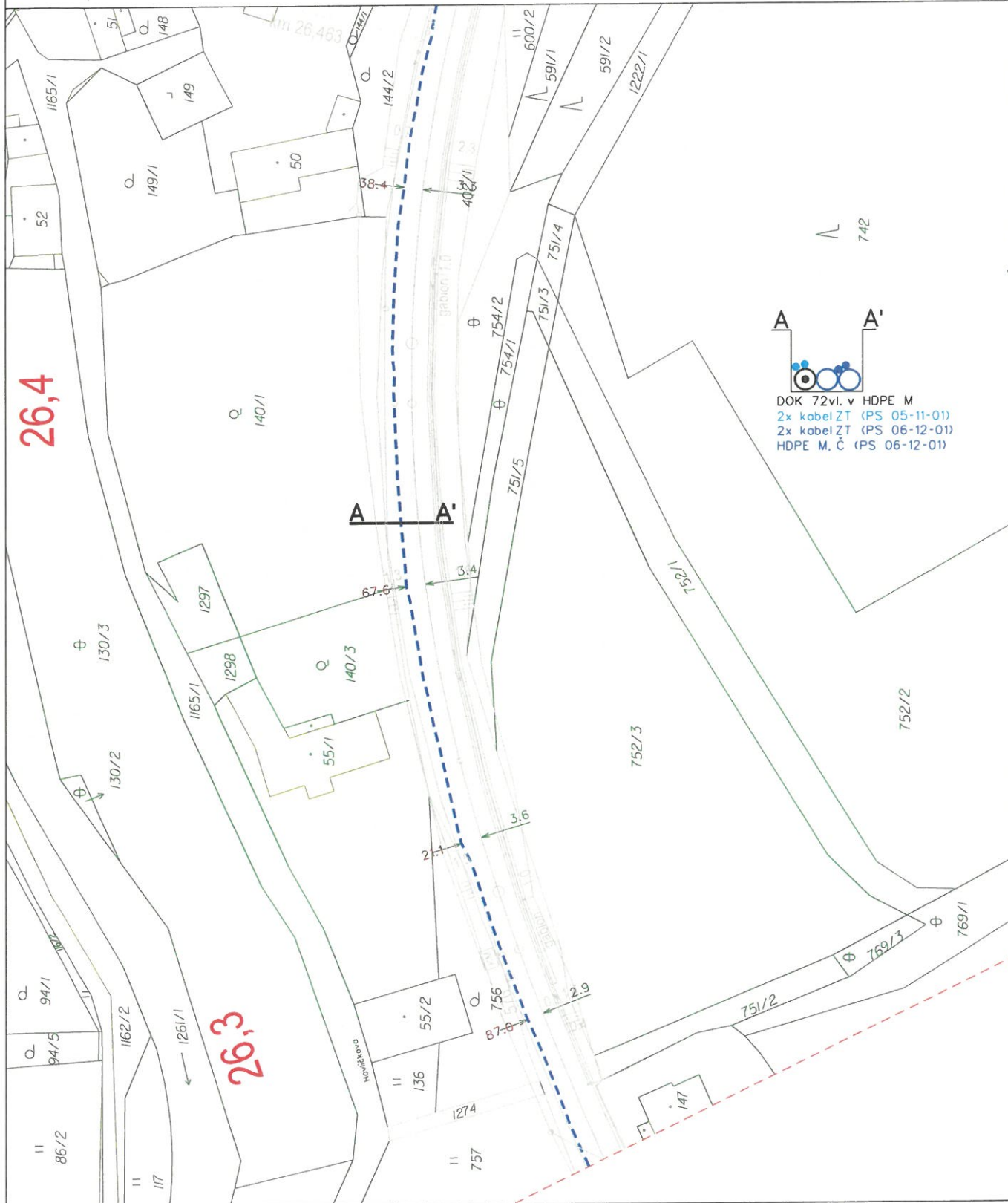

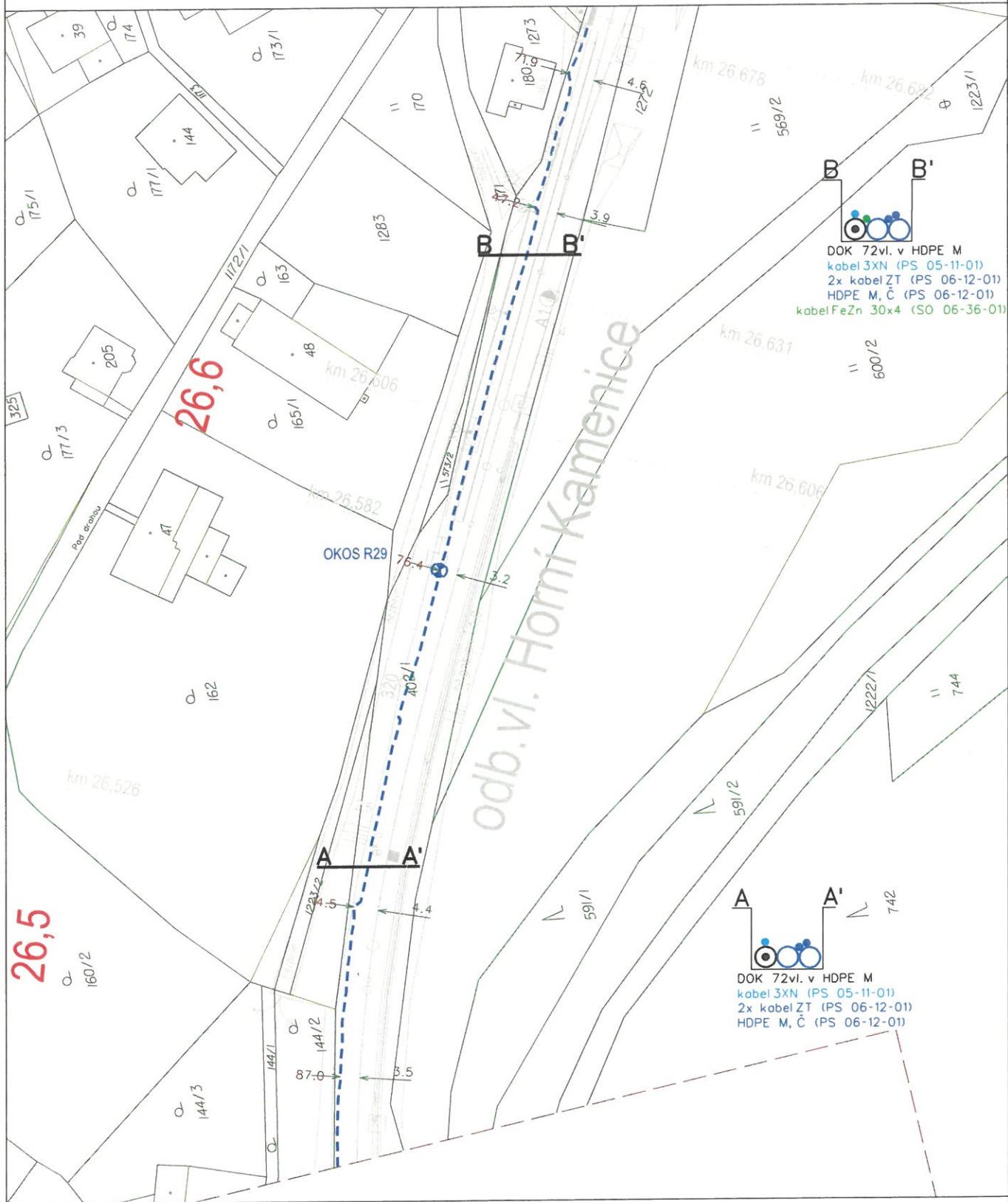

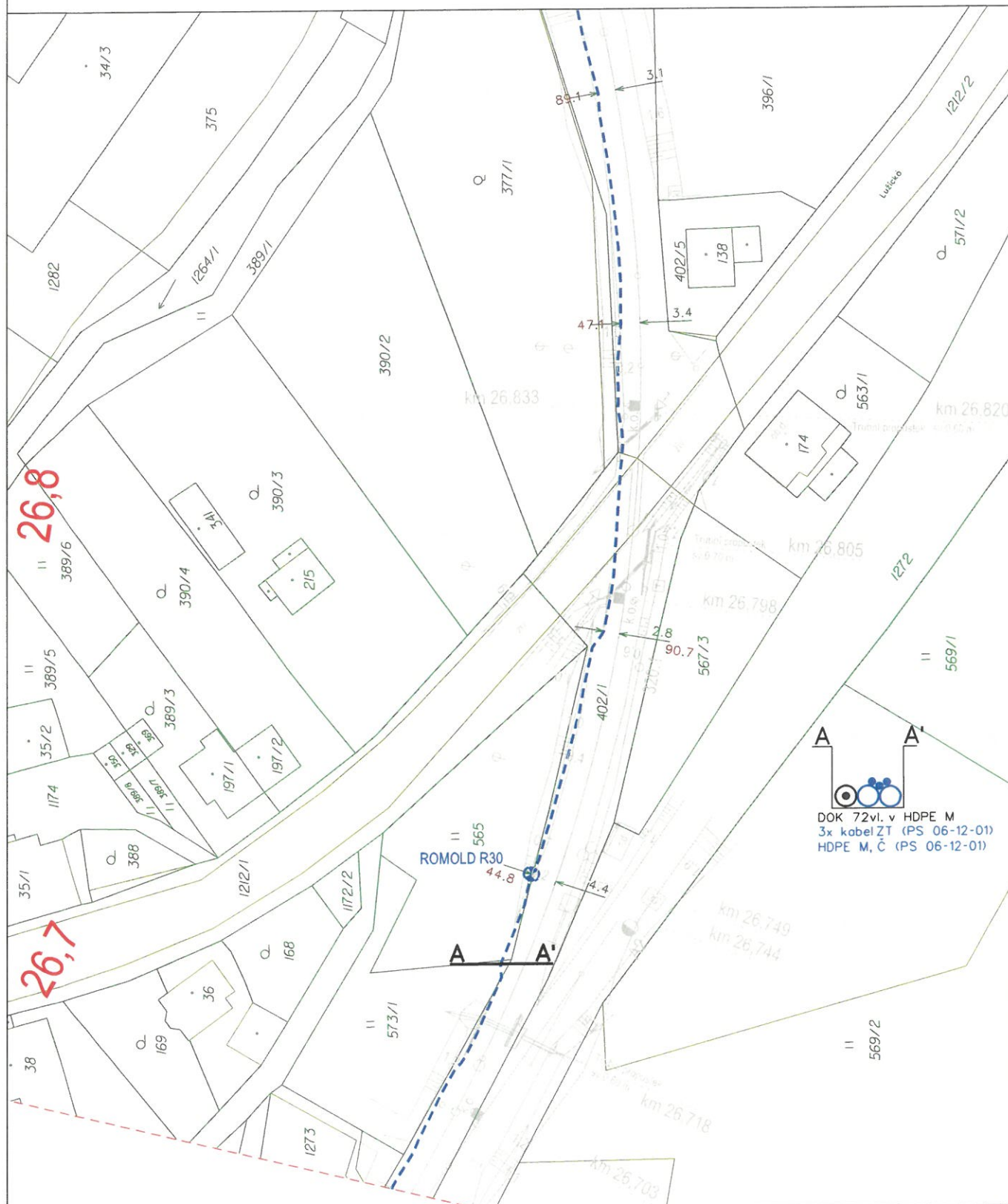

A A'

DOK 72vl. v HDPE M  
3x kabel ZT (PS 06-12-01)  
HDPE M, Č (PS 06-12-01)



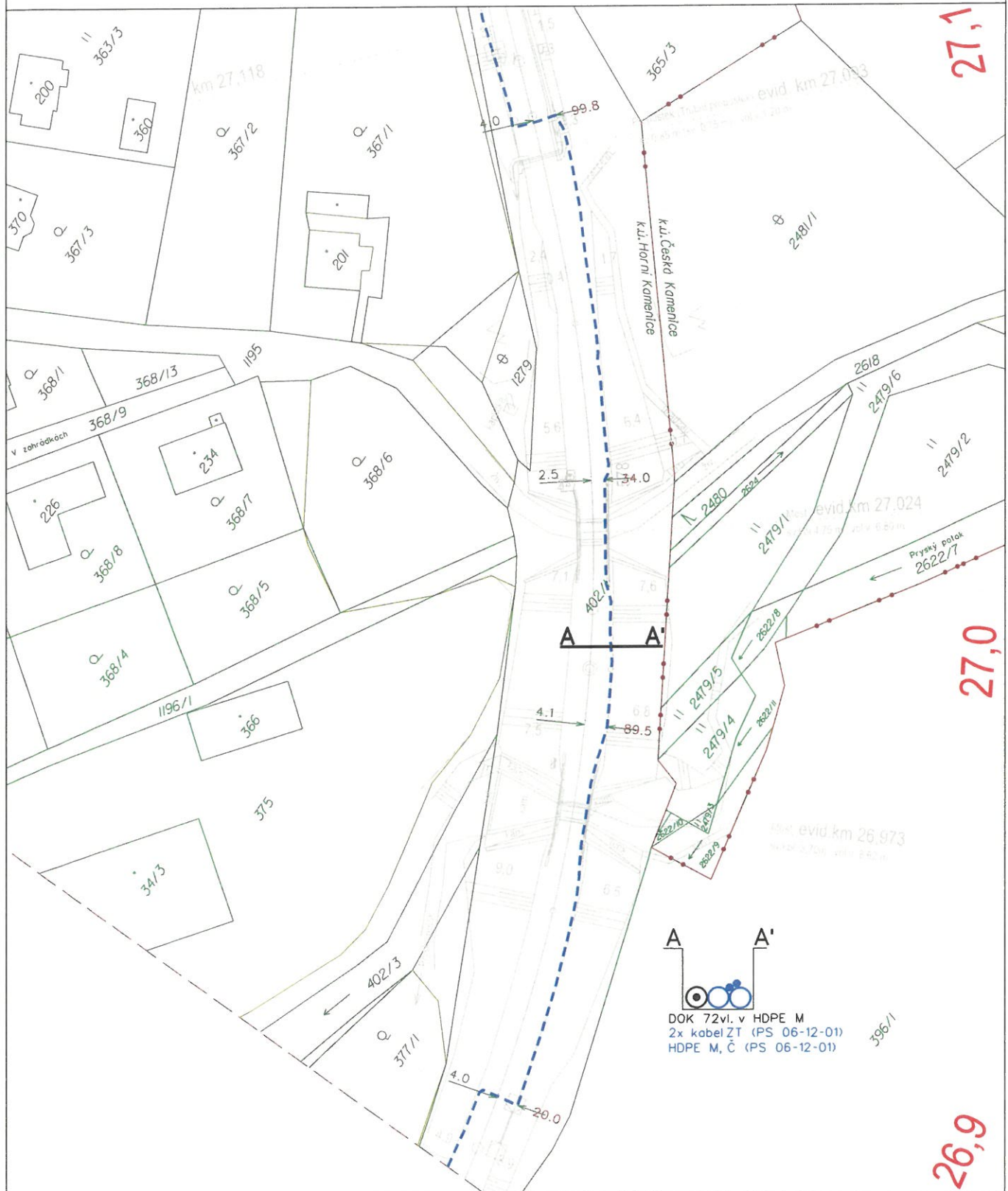

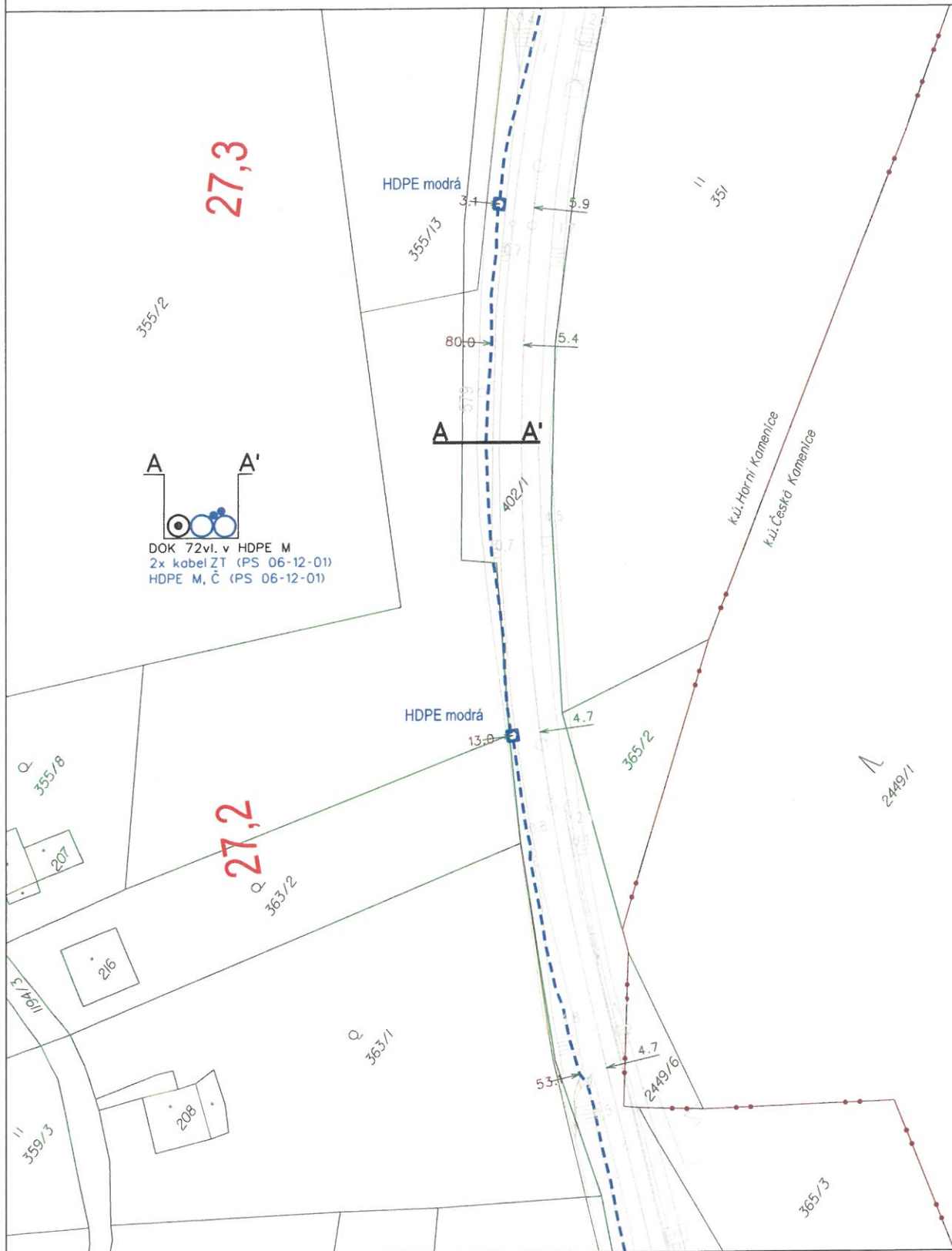

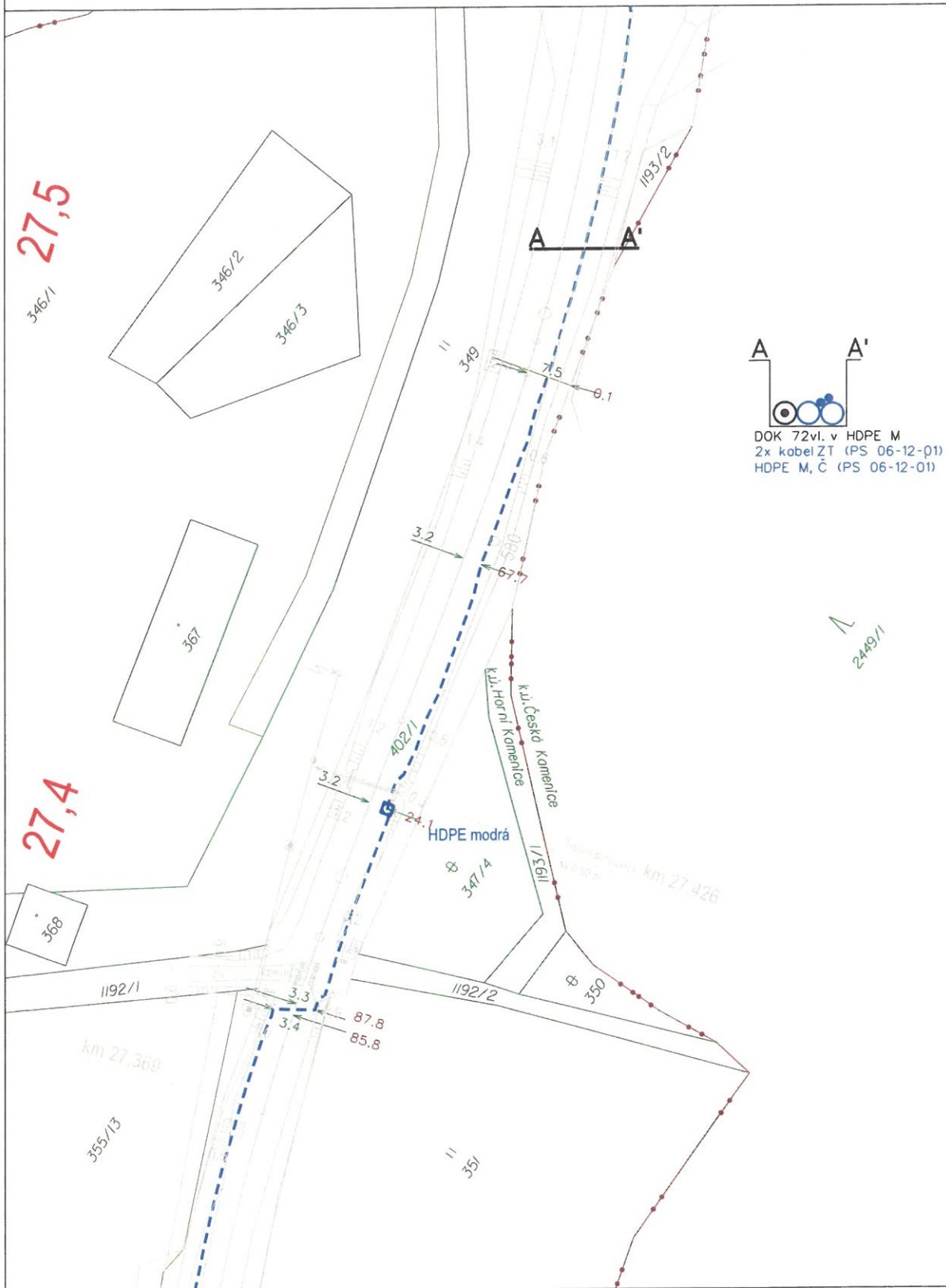

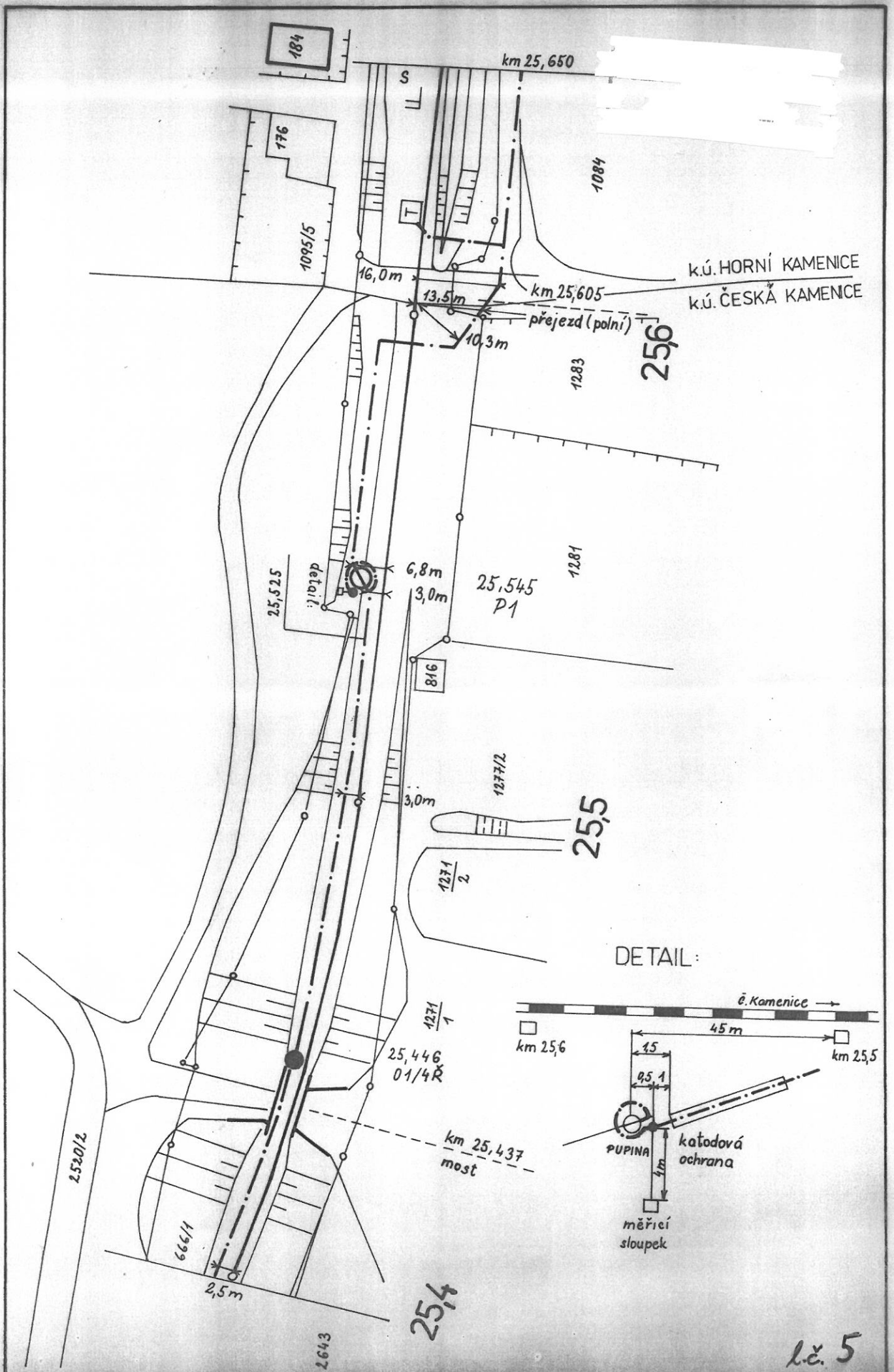

22

26

35/1

989

1244/5

402/1

996

996

25,8

25,7

25,9

25,748  
02/1

1083

1084

25 845 1GP1

km 25,896  
propust

km 25,650

12,0m

15,2m

15,5m

7

6

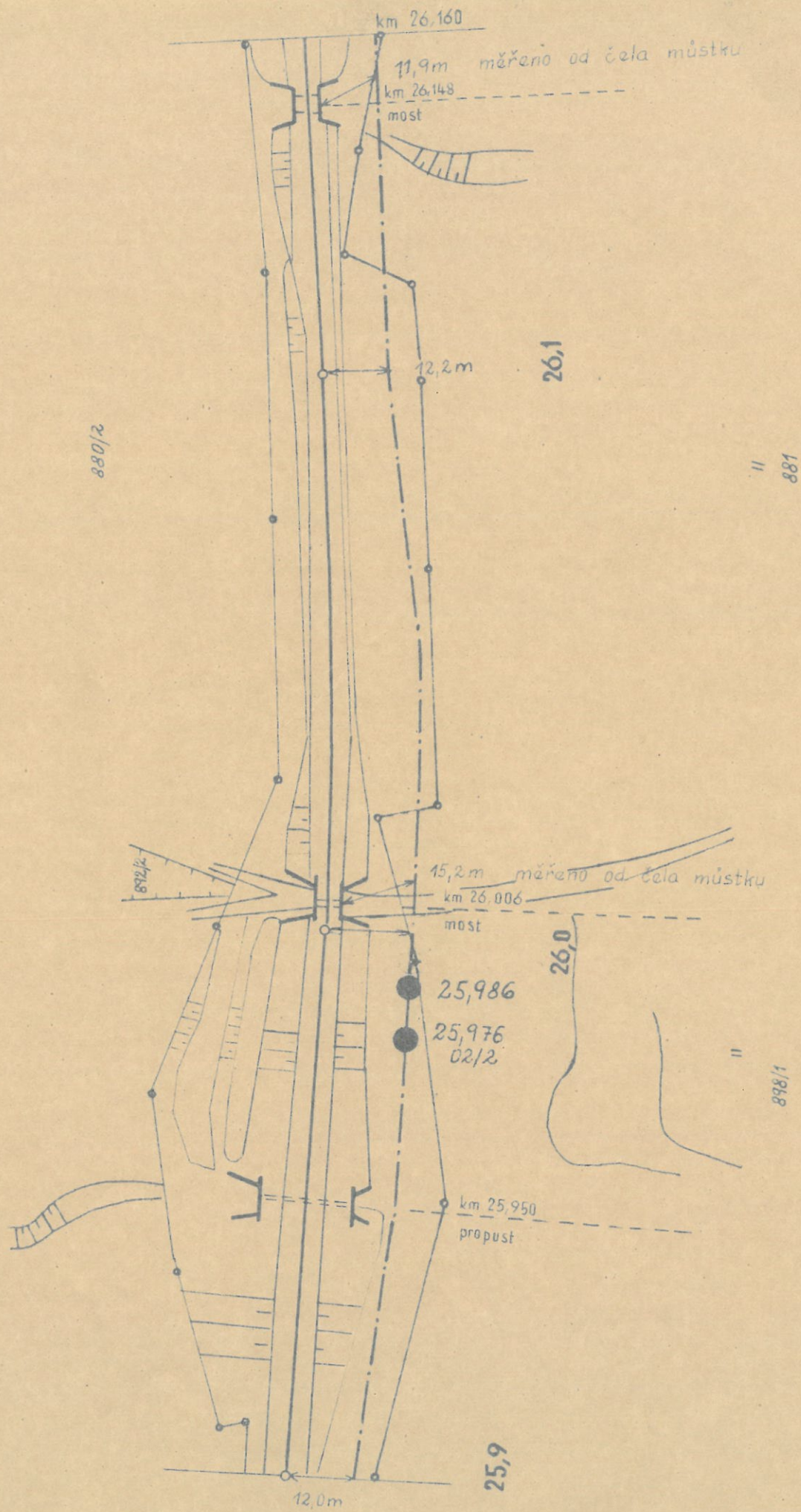

7

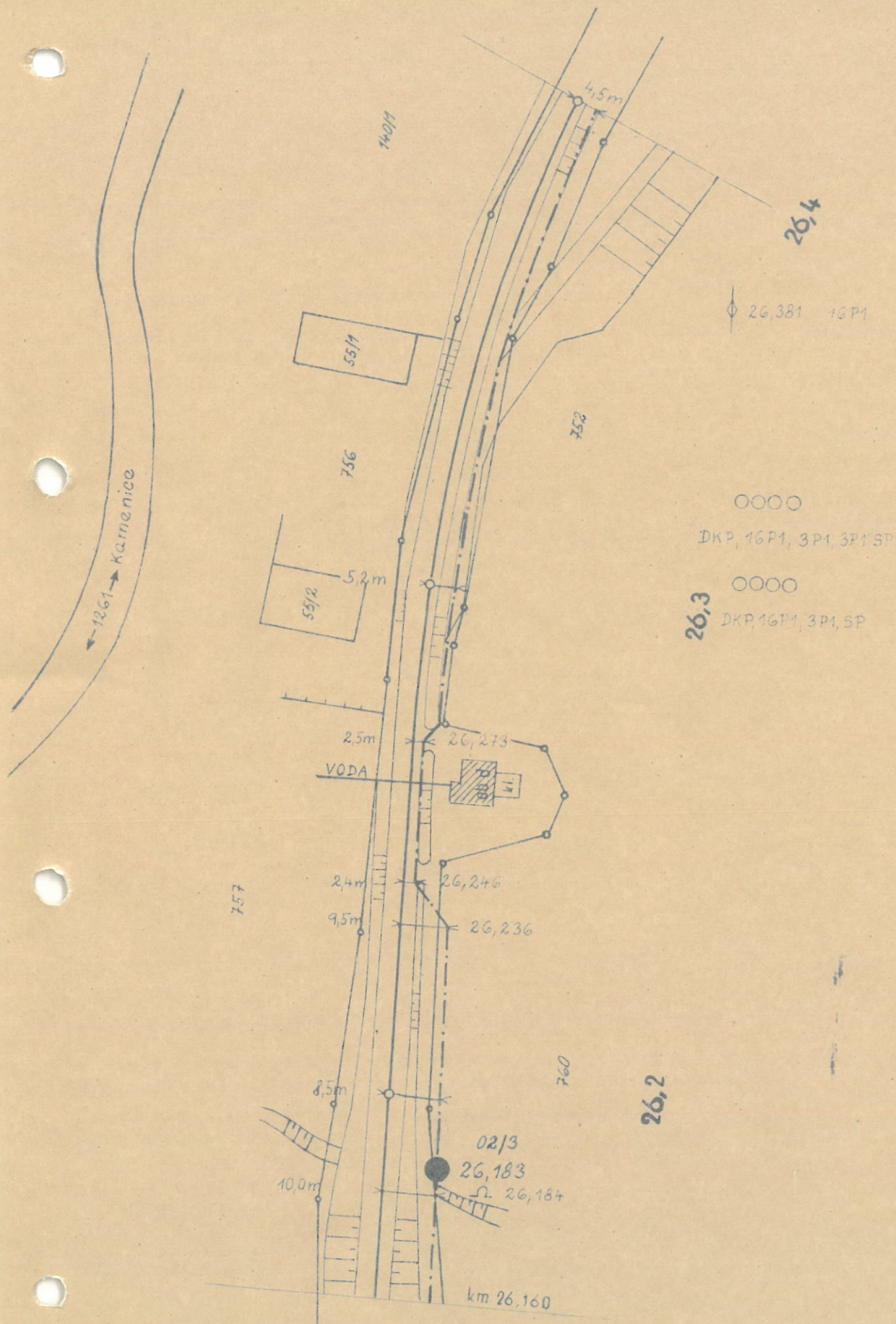

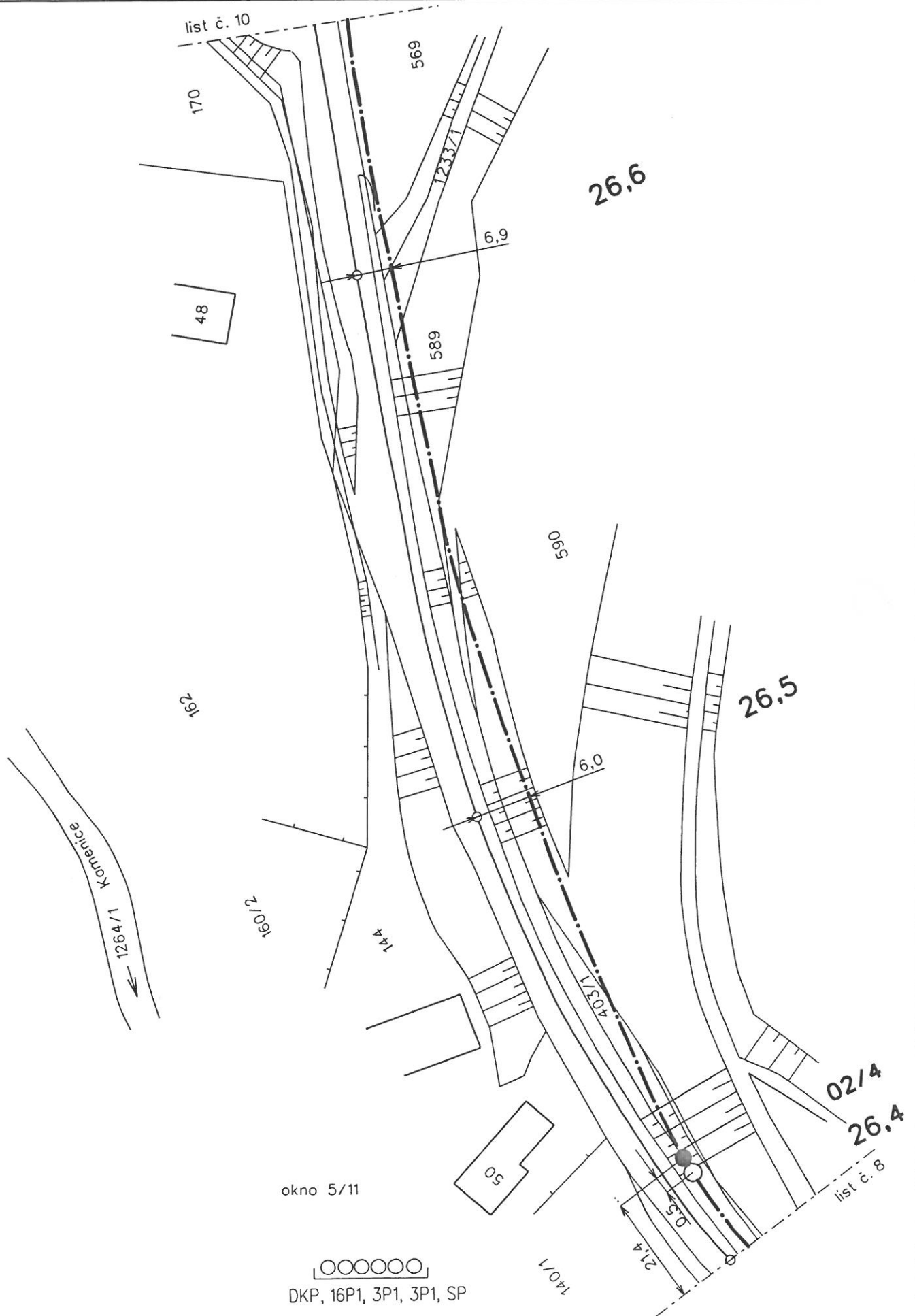
[illegible]

Zast. Horní Kamenice

170

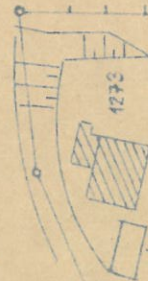

573/4

St. 4



km 26,650

26,652

02/5

1223/1

89

RD

1,5m

9,3m

- měřeno  
od kuse koleje

26,7

0,1

DKP, 1GP1, 3P1, 3P1, SP

00000

569

DKP, DKZ, 1GP1, SP

00000

0,2

0,266  
02/6

5-1  
0,297

11,4m  
0,3

40,0m od osy  
průjezdu

14,0m  
od kraje  
zábradlí  
propustku

PVC  
15

571/2

voškovod  
sítě 11kV

26,8

567/3

km 26,816  
průjezd - síť 11kV

563/2

114

563/1

EU

08/8

08/8

26,820

T

RZ

26,840

Lužická ul.

566

1212/1

373/1

3,2m

26,9

veřejné osvětlení  
od sloupu  
6,0m

10

7

375

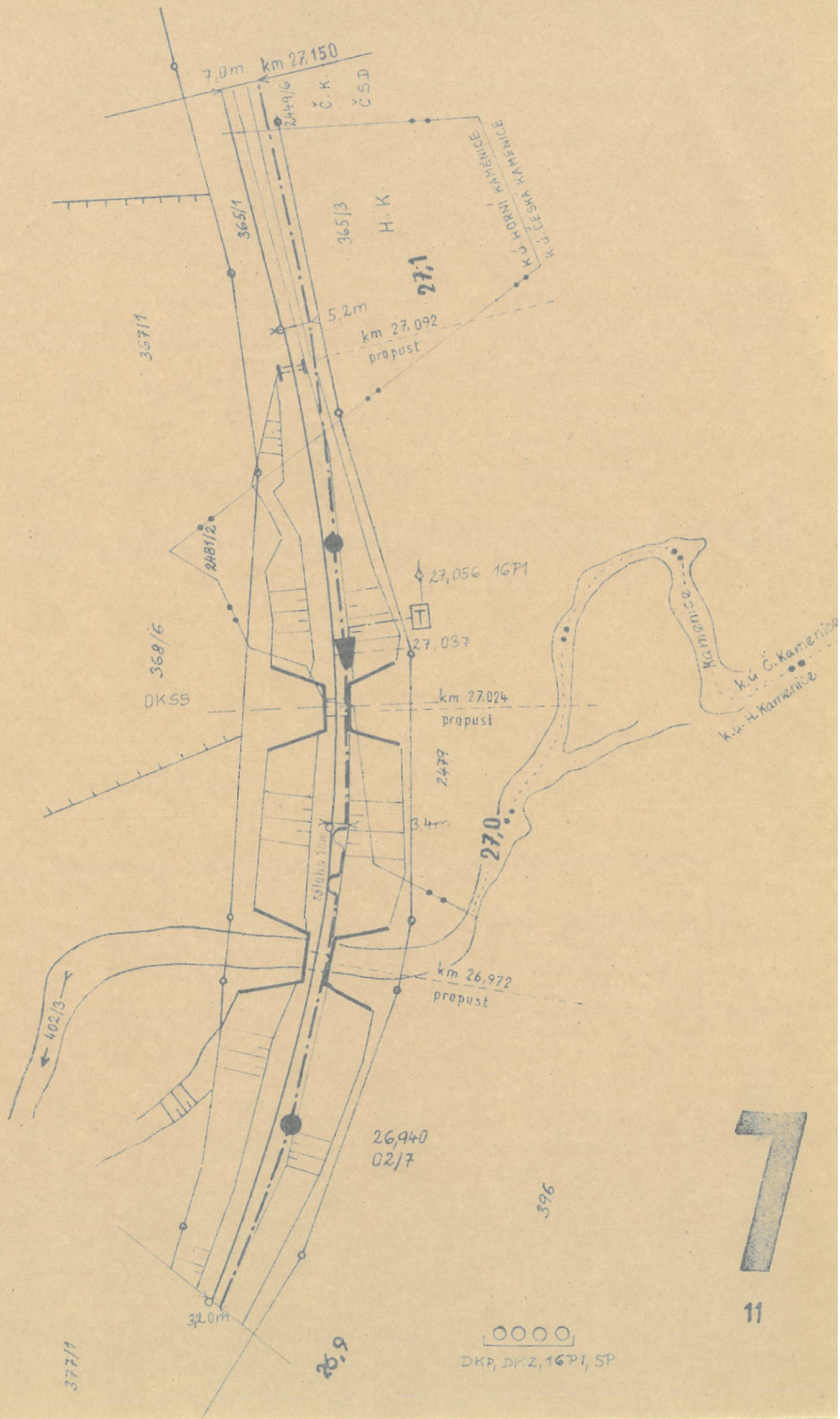

7

11

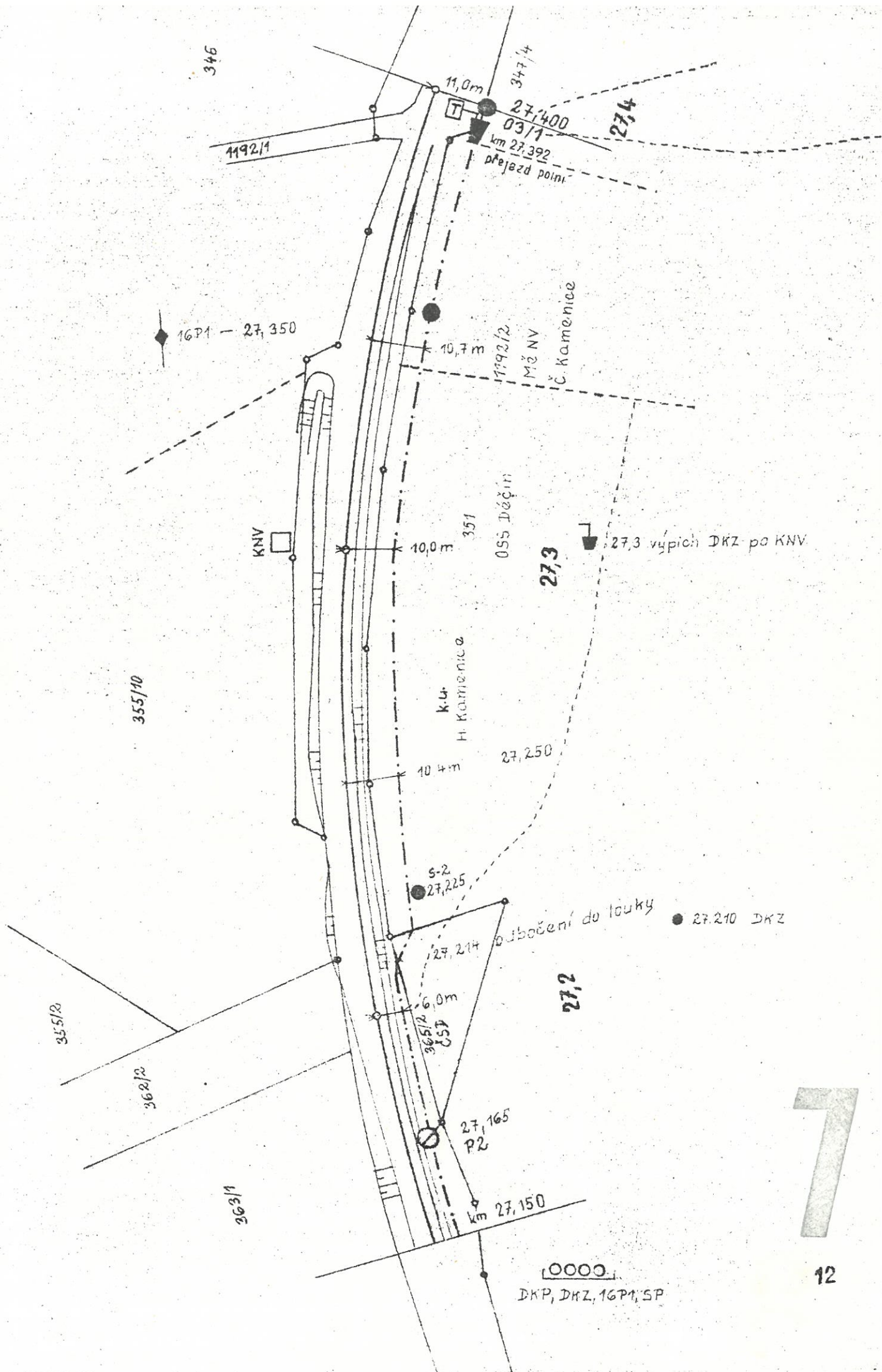

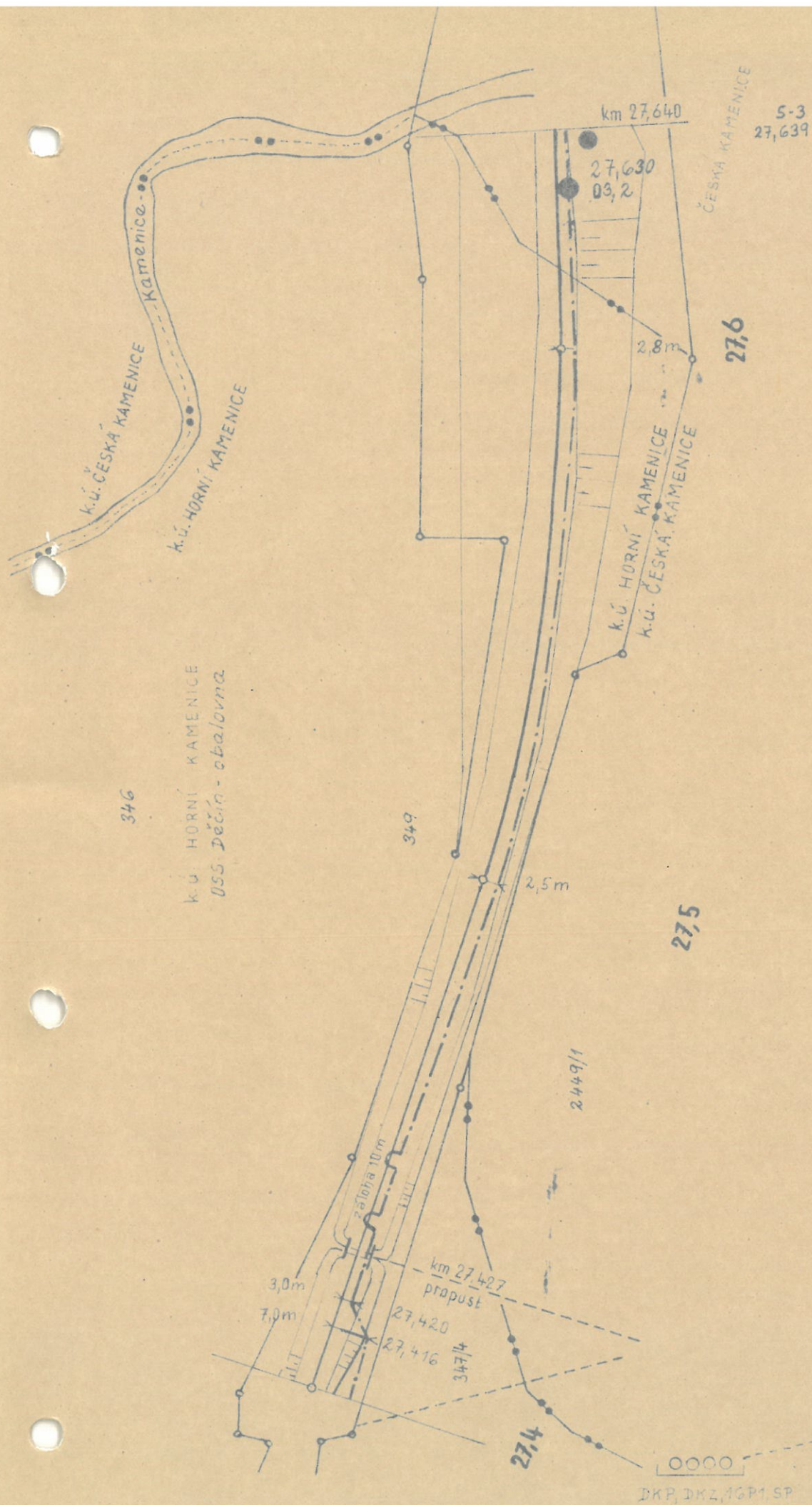

7

13